

**Moniteau School District
Maintenance Department
Moniteau High School
Annual Lead & Copper
Water Quality Test Results
August 2022**



1803 Philadelphia Street
 Indiana, PA 15701
 P: (724) 463-8378
 F: (724) 465-4209
 PADEP: 32-00382

1276 Bentleyville Road
 Van Voorhis, PA 15366
 P: (724) 258-8378
 F: (724) 258-8376
 PADEP: 63-04247

435 Broad Street
 Montoursville, PA 17754
 P: (570) 321-9002
 F: (570) 321-1957
 PADEP: 41-04880

950 West Main Street
 Sharpville, PA 16150
 P: (724) 463-8378 x 500
 F: (724) 465-4209
 PADEP: 43-04934

29 August 2022

Moniteau School District
 Attn: Jeffrey Campbell
 1810 West Sunbury Road
 West Sunbury, PA 16061

Work Order: 22H2154
Project: Drinking Water Moniteau Jr/Sr - Lead and Copper
Project Description: Drinking Water

Report of Analysis

Client Sample ID	Lab Sample ID	Matrix	Date Sampled	Date Received	Sample Notes
(1) Custodial Breakroom Sink	22H2154-01	Drinking Water	08/18/2022 06:00	8/18/22 14:00	
(2) Faculty Restroom Sink	22H2154-02	Drinking Water	08/18/2022 06:05	8/18/22 14:00	
(3) 100 Hall South Boys Restroom Sink	22H2154-03	Drinking Water	08/18/2022 06:10	8/18/22 14:00	
(4) Admin Office Breakroom Sink	22H2154-04	Drinking Water	08/18/2022 06:15	8/18/22 14:00	
(5) 300 Hall South Boys Restroom Sink	22H2154-05	Drinking Water	08/18/2022 06:20	8/18/22 14:00	
(6) 600 Hall Boys Restroom Sink	22H2154-06	Drinking Water	08/18/2022 06:25	8/18/22 14:00	
(7) Cafeteria Kitchen Sink	22H2154-07	Drinking Water	08/18/2022 06:30	8/18/22 14:00	
(8) 400 Hall Boys Restroom Sink	22H2154-08	Drinking Water	08/18/2022 06:35	8/18/22 14:00	
(9) 100 Hall North Boys Restroom Sink	22H2154-09	Drinking Water	08/18/2022 06:40	8/18/22 14:00	
(10) 300 Hall North Boys Restroom Sink	22H2154-10	Drinking Water	08/18/2022 06:45	8/18/22 14:00	

Report Narrative

The results contained in this report are only representative of the samples received. Environmental Service Laboratories, Inc. is not responsible for use or interpretation of the data included herein.

Definitions

RL Reporting Limit

Certifications

Analyses performed by Environmental Service Laboratories, Inc., Indiana PA unless otherwise specified.

Environmental Service Laboratories, Inc., Indiana, PA/TNI Certification #32-00382

Approved By

Kirsten Conoran

Kirsten Conoran
 Project Manager





1803 Philadelphia Street
 Indiana, PA 15701
 P: (724) 463-8378
 F: (724) 465-4209
 PADEP: 32-00382

1276 Bentleyville Road
 Van Voorhis, PA 15366
 P: (724) 258-8378
 F: (724) 258-8376
 PADEP: 63-04247

435 Broad Street
 Montoursville, PA 17754
 P: (570) 321-9002
 F: (570) 321-1957
 PADEP: 41-04880

950 West Main Street
 Sharpsville, PA 16150
 P: (724) 463-8378 x 500
 F: (724) 465-4209
 PADEP: 43-04934

Moniteau School District
 1810 West Sunbury Road
 West Sunbury, PA 16061

Reported: 08/29/2022 14:23

Lab Sample ID#: 22H2154-01
Sample Type: Drinking Water
Sample Source: Grab
Sampler: Client
Client Sample ID: (1) Custodial Breakroom Sink

Sample Date: 08/18/2022 06:00
Receipt Date: 08/18/2022 14:00

Analyte	Sample Result	Units	Data Qualifier	RL	Analyst/Certification	Prep Date/Time	Analysis Date/Time
Total Metals	Analytical Method: EPA200.5 4.2				Prep Method: EPA 200.5 4.2		
Copper	0.039	mg/L		0.002	ANO	08/19/22 12:09	08/26/22 07:46
Lead	<0.0025	mg/L		0.0025	ANO	08/19/22 12:09	08/26/22 07:46

Lab Sample ID#: 22H2154-02
Sample Type: Drinking Water
Sample Source: Grab
Sampler: Client
Client Sample ID: (2) Faculty Restroom Sink

Sample Date: 08/18/2022 06:05
Receipt Date: 08/18/2022 14:00

Analyte	Sample Result	Units	Data Qualifier	RL	Analyst/Certification	Prep Date/Time	Analysis Date/Time
Total Metals	Analytical Method: EPA200.5 4.2				Prep Method: EPA 200.5 4.2		
Copper	0.12	mg/L		0.002	ANO	08/19/22 12:09	08/26/22 07:48
Lead	<0.0025	mg/L		0.0025	ANO	08/19/22 12:09	08/26/22 07:48

Lab Sample ID#: 22H2154-03
Sample Type: Drinking Water
Sample Source: Grab
Sampler: Client
Client Sample ID: (3) 100 Hall South Boys Restroom Sink

Sample Date: 08/18/2022 06:10
Receipt Date: 08/18/2022 14:00

Analyte	Sample Result	Units	Data Qualifier	RL	Analyst/Certification	Prep Date/Time	Analysis Date/Time
Total Metals	Analytical Method: EPA200.5 4.2				Prep Method: EPA 200.5 4.2		
Copper	0.025	mg/L		0.002	ANO	08/19/22 12:09	08/26/22 07:50
Lead	<0.0025	mg/L		0.0025	ANO	08/19/22 12:09	08/26/22 07:50



1803 Philadelphia Street
 Indiana, PA 15701
 P: (724) 463-8378
 F: (724) 465-4209
 PADEP: 32-00382

1276 Bentleyville Road
 Van Voorhis, PA 15366
 P: (724) 258-8378
 F: (724) 258-8376
 PADEP: 63-04247

435 Broad Street
 Montoursville, PA 17754
 P: (570) 321-9002
 F: (570) 321-1957
 PADEP: 41-04880

950 West Main Street
 Sharpville, PA 16150
 P: (724) 463-8378 x 500
 F: (724) 465-4209
 PADEP: 43-04934

Moniteau School District
 1810 West Sunbury Road
 West Sunbury, PA 16061

Reported: 08/29/2022 14:23

Lab Sample ID#: 22H2154-04
Sample Type: Drinking Water
Sample Source: Grab
Sampler: Client
Client Sample ID: (4) Admin Office Breakroom Sink

Sample Date: 08/18/2022 06:15
Receipt Date: 08/18/2022 14:00

Analyte	Sample Result	Units	Data Qualifier	RL	Analyst/Certification	Prep Date/Time	Analysis Date/Time
Total Metals	Analytical Method: EPA200.5 4.2				Prep Method: EPA 200.5 4.2		
Copper	0.25	mg/L		0.002	ANO	08/19/22 12:09	08/26/22 07:53
Lead	<0.0025	mg/L		0.0025	ANO	08/19/22 12:09	08/26/22 07:53

Lab Sample ID#: 22H2154-05
Sample Type: Drinking Water
Sample Source: Grab
Sampler: Client
Client Sample ID: (5) 300 Hall South Boys Restroom Sink

Sample Date: 08/18/2022 06:20
Receipt Date: 08/18/2022 14:00

Analyte	Sample Result	Units	Data Qualifier	RL	Analyst/Certification	Prep Date/Time	Analysis Date/Time
Total Metals	Analytical Method: EPA200.5 4.2				Prep Method: EPA 200.5 4.2		
Copper	0.23	mg/L		0.002	ANO	08/19/22 12:09	08/26/22 07:55
Lead	<0.0025	mg/L		0.0025	ANO	08/19/22 12:09	08/26/22 07:55

Lab Sample ID#: 22H2154-06
Sample Type: Drinking Water
Sample Source: Grab
Sampler: Client
Client Sample ID: (6) 600 Hall Boys Restroom Sink

Sample Date: 08/18/2022 06:25
Receipt Date: 08/18/2022 14:00

Analyte	Sample Result	Units	Data Qualifier	RL	Analyst/Certification	Prep Date/Time	Analysis Date/Time
Total Metals	Analytical Method: EPA200.5 4.2				Prep Method: EPA 200.5 4.2		
Copper	0.039	mg/L		0.002	ANO	08/19/22 12:09	08/26/22 07:58
Lead	<0.0025	mg/L		0.0025	ANO	08/19/22 12:09	08/26/22 07:58



1803 Philadelphia Street
 Indiana, PA 15701
 P: (724) 463-8378
 F: (724) 465-4209
 PADEP: 32-00382

1276 Bentleyville Road
 Van Voorhis, PA 15366
 P: (724) 258-8378
 F: (724) 258-8376
 PADEP: 63-04247

435 Broad Street
 Montoursville, PA 17754
 P: (570) 321-9002
 F: (570) 321-1957
 PADEP: 41-04880

950 West Main Street
 Sharpsville, PA 16150
 P: (724) 463-8378 x 500
 F: (724) 465-4209
 PADEP: 43-04934

Moniteau School District
 1810 West Sunbury Road
 West Sunbury, PA 16061

Reported: 08/29/2022 14:23

Lab Sample ID#: 22H2154-07
Sample Type: Drinking Water
Sample Source: Grab
Sampler: Client
Client Sample ID: (7) Cafeteria Kitchen Sink

Sample Date: 08/18/2022 06:30
Receipt Date: 08/18/2022 14:00

Analyte	Sample Result	Units	Data Qualifier	RL	Analyst/Certification	Prep Date/Time	Analysis Date/Time
Total Metals	Analytical Method: EPA200.5 4.2				Prep Method: EPA 200.5 4.2		
Copper	0.21	mg/L		0.002	ANO	08/19/22 12:09	08/26/22 07:19
Lead	<0.0025	mg/L		0.0025	ANO	08/19/22 12:09	08/26/22 07:19

Lab Sample ID#: 22H2154-08
Sample Type: Drinking Water
Sample Source: Grab
Sampler: Client
Client Sample ID: (8) 400 Hall Boys Restroom Sink

Sample Date: 08/18/2022 06:35
Receipt Date: 08/18/2022 14:00

Analyte	Sample Result	Units	Data Qualifier	RL	Analyst/Certification	Prep Date/Time	Analysis Date/Time
Total Metals	Analytical Method: EPA200.5 4.2				Prep Method: EPA 200.5 4.2		
Copper	0.033	mg/L		0.002	ANO	08/19/22 12:09	08/26/22 08:00
Lead	<0.0025	mg/L		0.0025	ANO	08/19/22 12:09	08/26/22 08:00

Lab Sample ID#: 22H2154-09
Sample Type: Drinking Water
Sample Source: Grab
Sampler: Client
Client Sample ID: (9) 100 Hall North Boys Restroom Sink

Sample Date: 08/18/2022 06:40
Receipt Date: 08/18/2022 14:00

Analyte	Sample Result	Units	Data Qualifier	RL	Analyst/Certification	Prep Date/Time	Analysis Date/Time
Total Metals	Analytical Method: EPA200.5 4.2				Prep Method: EPA 200.5 4.2		
Copper	0.031	mg/L		0.002	ANO	08/19/22 12:10	08/26/22 08:17
Lead	<0.0025	mg/L		0.0025	ANO	08/19/22 12:10	08/26/22 08:17



1803 Philadelphia Street
 Indiana, PA 15701
 P: (724) 463-8378
 F: (724) 465-4209
 PADEP: 32-00382

1276 Bentleyville Road
 Van Voorhis, PA 15366
 P: (724) 258-8378
 F: (724) 258-8376
 PADEP: 63-04247

435 Broad Street
 Montoursville, PA 17754
 P: (570) 321-9002
 F: (570) 321-1957
 PADEP: 41-04880

950 West Main Street
 Sharpsville, PA 16150
 P: (724) 463-8378 x 500
 F: (724) 465-4209
 PADEP: 43-04934

Moniteau School District
 1810 West Sunbury Road
 West Sunbury, PA 16061

Reported: 08/29/2022 14:23

Lab Sample ID#: 22H2154-10
Sample Type: Drinking Water
Sample Source: Grab
Sampler: Client
Client Sample ID: (10) 300 Hall North Boys Restroom Sink

Sample Date: 08/18/2022 06:45
Receipt Date: 08/18/2022 14:00

Analyte	Sample Result	Units	Data Qualifier	RL	Analyst/ Certification	Prep Date/Time	Analysis Date/Time
Total Metals	Analytical Method: EPA200.5 4.2				Prep Method: EPA 200.5 4.2		
Copper	0.034	mg/L		0.002	ANO	08/19/22 12:10	08/26/22 08:20
Lead	<0.0025	mg/L		0.0025	ANO	08/19/22 12:10	08/26/22 08:20

RE 1 OF 1

ENVIRONMENTAL SERVICE LABORATORIES, INC.

HEADQUARTER
1803 Philadelphia St.
Indiana, PA 15701
(724) 463-TEST
FAX: (724) 465-4209

SOUTHERN DIVISION
1276 Bentleyville Road
Van Voorhis, PA 15386
(724) 258-TEST
FAX: (724) 258-8376

NORTHERN DIVISION
495 Broad Street
Montoursville, PA 17754
(570) 321-9003
FAX: (570) 321-1957

NORTHWEST DIVISION
950 Main Street
Sharpsville, PA 16150
(724) 463-TEST
FAX: (724) 465-4209

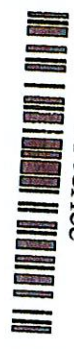

22H2154

FOR INTERNAL LABORATORY USE ONLY

Sample Identification	ESL#	Sample Type		Matrix	# of Bottles	Container Type	Analysis Requested
		Grab	Time				
(1) Custodial Breakroom Sink		8/18	06:00	DW	1	PLASTIC LITER HNO3	LEAD AND COPPER
(2) Faculty Restroom Sink		8/18	06:05	DW	1	PLASTIC LITER HNO3	LEAD AND COPPER
(3) 100 Hall South Boys Restroom Sink		8/18	06:00	DW	1	PLASTIC LITER HNO3	LEAD AND COPPER
(4) Admin office Breakroom Sink		8/18	06:15	DW	1	PLASTIC LITER HNO3	LEAD AND COPPER
(5) 300 Hall South Boys Restroom Sink		8/18	06:20	DW	1	PLASTIC LITER HNO3	LEAD AND COPPER
(6) 100 Hall Boys Restroom Sink		8/18	06:25	DW	1	PLASTIC LITER HNO3	LEAD AND COPPER
(7) Cafeteria Kitchen Sink		8/18	06:30	DW	1	PLASTIC LITER HNO3	LEAD AND COPPER
(8) 400 Hall Boys Restroom Sink		8/18	06:35	DW	1	PLASTIC LITER HNO3	LEAD AND COPPER
(9) 100 Hall North Boys Restroom Sink		8/18	06:40	DW	1	PLASTIC LITER HNO3	LEAD AND COPPER
(10) 300 Hall North Boys Restroom Sink		8/18	06:45	DW	1	PLASTIC LITER HNO3	LEAD AND COPPER

Notes/Special Instructions:

Drinking Water Moniteau Jr/Sr - Lead and Copper (10)

- THESE SERVICE CHARGES WILL ACCRUE AT THE RATE OF 1 1/2% PER MONTH (18% PER ANNUM OR THE MAXIMUM ALLOWED BY LAW.)
- THE UNDERSIGNED PURCHASER AGREES TO PAY, IN THE EVENT HIS ACCOUNT BECOMES DELINQUENT AND IS TURNED OVER TO ANY ATTORNEY FOR COLLECTION, REASONABLE ATTORNEY'S FEES PLUS ALL COURT AND ATTENDANT COLLECTION COSTS.

THE UNDERSIGNED PURCHASER HEREBY AGREES TO PAY SERVICE CHARGES ON ACCOUNTS OVER 31 DAYS OLD.

Company Name: **MONITEAU SCHOOL DISTRICT**

Address: **1810 WEST SUNBURY ROAD
WEST SUNBURY, PA 16061
JEFFREY CAMPBELL**

Contact Person: **JEFFREY CAMPBELL**

Phone Number: **724-406-4426**

Cell Phone: **jcampbell@moniteau.org**

Email Address: **jcampbell@moniteau.org**

Billing Address: **jcampbell@moniteau.org**

PWSID: **5100324**

Sampled By: (Signature) *[Signature]* Date/Time **8/18/22 1100**

Relinquished By: (Signature) *[Signature]* Date/Time **8/18/22 1100**

Relinquished By: (Signature) *[Signature]* Date/Time **8/18/22 1400**

Relinquished By: (Signature) *[Signature]* Date/Time **8/18/22 1400**

Relinquished By: (Signature) *[Signature]* Date/Time **8/18/22 1400**

Correct Preservations Y / N / N A Correct Containers Y / N / N A Receipt Temperature _____



22H2154

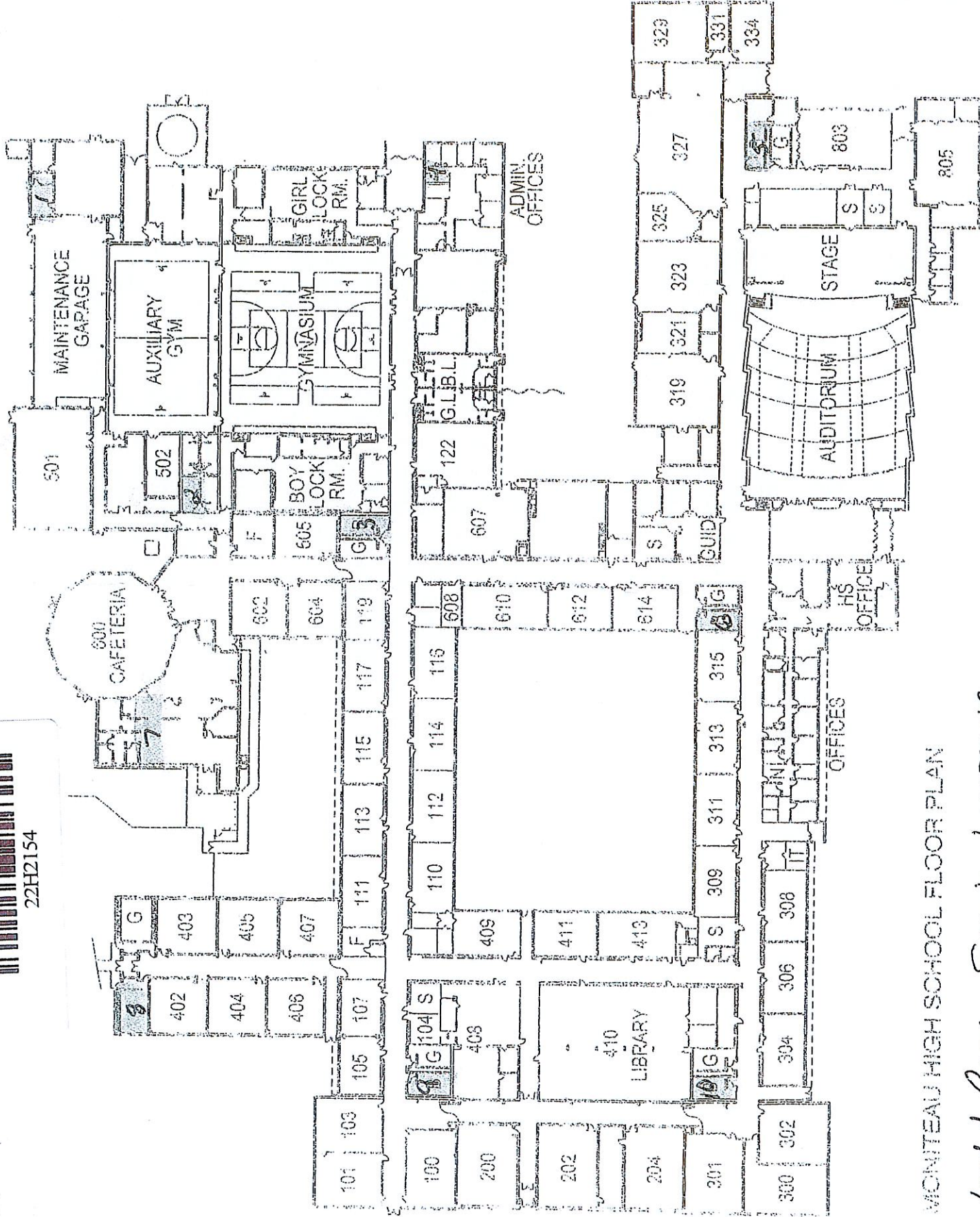

MONTICELLO HIGH SCHOOL FLOOR PLAN

Lead at Capree Sample Locations



SAMPLE RECEIPT AND REVIEW FORM

Client: <u>Monitau</u>	Work Order: <u>22H2154</u>
------------------------	----------------------------

PART A: GENERAL INFORMATION- SATELLITE LABORATORY

Received by/Lab ID:	Date/Time Received: <u> / /</u>
Method of Delivery: Client Drop-Off ESL Courier Other: _____	Received on Ice? YES NO
Sample Receipt Temperature: _____ °C	IR Gun ID: _____
Containers Removed by Satellite Lab for Analysis of: <u>FECAL TC/EC TC MPN EC MPN TC/EC MPN N/A</u>	

PART B: GENERAL INFORMATION- INDIANA LABORATORY

Received by/Lab ID: <u>PA/10362</u>	Samples Received on Ice? <u>YES</u> NO
Date/Time Received: <u>8/18/22 1400</u>	Date Sampled: <u>8/18/22</u>
Method of Delivery: FedEx UPS Client Drop off <u>ESL courier</u> Other: _____	
Sample Receipt Temperature: <u>3.1</u> °C	IR Gun ID: <u>3</u>
Sample State of Collection: <u>PA</u> NY OH WV Other: _____	PWSID Compliance Drinking Water Samples: YES <u>NO</u>

PART C: Receipt Details Completed (if different from above):

Sample Receipt Criteria	Signature _____		Date _____		Comments/Qualifiers (Required for Non-Conforming Items)
	YES	NO		Time	
Chain of custody documents included with samples?	<u>YES</u>	NO			Comments:
COC form is properly signed in relinquished/received sections?	YES	NO			Comments:
Sample containers intact and sealed?	YES	NO			Circle Applicable: Damaged Container Leaking Container Custody Seal Broken Other: _____
Number of containers received matches number indicated on COC?	YES	NO			Sample IDs and Containers Affected:
Sample IDs on COC match IDs on bottles?	YES	NO			Sample IDs and Containers Affected:
Date and time on COC match date and time on bottles?	YES	NO			Sample IDs and Containers Affected:
Samples received within holding time?	YES	NO			Sample IDs and Containers Affected:
Samples received at appropriate pH for analysis requested?	YES	NO			Sample IDs and Containers Affected and Observed pH:
Samples requiring thermal preservation within 0 ≤ 6°C? Microbiology within 0 ≤ 10°C?	YES	NO			For non-WV samples outside of thermal preservation range sampled same day and received on ice are considered acceptable as long as the cooling process has begun.
Adequate sample volume received?	YES	NO			Analyses Affected:
VOA vials free of headspace (defined as < 6 mm bubble)?	YES	<u>NO</u>			Sample IDs and Containers Affected:
Other Comments:					
					Deficiency Log Created: YES <u>NO</u>



E-Government Application for Drinking Water Program
SAFE DRINKING WATER ACT
 VIEW/EDIT RECORDS

5100324: MONITEAU JR/SR HIGH SCHOOL
SDWA1

PWSID	Contam ID	Contam	Analysis Method	Result	Analysis Date	Location ID 1	Location ID 2	Sample Date	Sample Type	Sample Time	Lab ID	Sample ID	Record ID
5100324	1022	COPPER	171	0.031	082622	1HN		081822	D	0640	32382	22H2154-09	BROWNKA_2823
5100324	1030	LEAD	171	0.0	082622	1HN		081822	D	0640	32382	22H2154-09	BROWNKA_2832
5100324	1022	COPPER	171	0.025	082622	1HS		081822	D	0610	32382	22H2154-03	BROWNKA_2822
5100324	1030	LEAD	171	0.0	082622	1HS		081822	D	0610	32382	22H2154-03	BROWNKA_2833
5100324	1022	COPPER	171	0.034	082622	3HN		081822	D	0645	32382	22H2154-10	BROWNKA_2825
5100324	1030	LEAD	171	0.0	082622	3HN		081822	D	0645	32382	22H2154-10	BROWNKA_2834
5100324	1022	COPPER	171	0.23	082622	3HS		081822	D	0620	32382	22H2154-05	BROWNKA_2830
5100324	1030	LEAD	171	0.0	082622	3HS		081822	D	0620	32382	22H2154-05	BROWNKA_2835
5100324	1022	COPPER	171	0.033	082622	400		081822	D	0635	32382	22H2154-08	BROWNKA_2824
5100324	1030	LEAD	171	0.0	082622	400		081822	D	0635	32382	22H2154-08	BROWNKA_2836
5100324	1022	COPPER	171	0.039	082622	600		081822	D	0625	32382	22H2154-06	BROWNKA_2826
5100324	1030	LEAD	171	0.0	082622	600		081822	D	0625	32382	22H2154-06	BROWNKA_2837
5100324	1013	FREE CHLORINE	301	0.78	081122	704		081122	D	1033	32382	22H1365-01	BROWNKA_586
5100324	1013	FREE CHLORINE	301	1.08	080422	802		080422	D	1145	32382	22H0702-01	BROWNKA_276
5100324	3100	TOTAL COLIFORM PRESENCE	331	0.0	080522	802		080422	D	1145	32382	22H0702-01	BROWNKA_277
5100324	1013	FREE CHLORINE	301	0.48	081822	803		081822	D	1100	32382	22H2225-01	BROWNKA_2046
5100324	1013	FREE CHLORINE	301	0.48	082522	804		082522	D	1050	32382	22H2795-01	BROWNKA_2771
5100324	1022	COPPER	171	0.25	082622	AOB		081822	D	0615	32382	22H2154-04	BROWNKA_2831
5100324	1030	LEAD	171	0.0	082622	AOB		081822	D	0615	32382	22H2154-04	BROWNKA_2838



E-Government Application for Drinking Water Program
SAFE DRINKING WATER ACT
VIEW/EDIT RECORDS

5100324: MONITEAU JR/SR HIGH SCHOOL

SDWA1

PWSID	Contam ID	Contam	Analysis Method	Result	Analysis Date	Location ID 1	Location ID 2	Sample Date	Sample Type	Sample Time	Lab ID	Sample ID	Record ID
5100324	1022	COPPER	171	0.039	082622	CBS		081822	D	0600	32382	22H2154-01	BROWNKA_2827
5100324	1030	LEAD	171	0.0	082622	CBS		081822	D	0600	32382	22H2154-01	BROWNKA_2839
5100324	1022	COPPER	171	0.21	082622	CKS		081822	D	0630	32382	22H2154-07	BROWNKA_2829
5100324	1030	LEAD	171	0.0	082622	CKS		081822	D	0630	32382	22H2154-07	BROWNKA_2840
5100324	1022	COPPER	171	0.12	082622	FRS		081822	D	0605	32382	22H2154-02	BROWNKA_2828
5100324	1030	LEAD	171	0.0	082622	FRS		081822	D	0605	32382	22H2154-02	BROWNKA_2841

5100324: MONITEAU JR/SR HIGH SCHOOL

SDWA4

PWSID	Contam ID	Contam	Analysis Method	Result	Lower Limit of Detection	Counting Error	Analysis Date	Loc/EP ID	Loc/EP ID 2	Sample Date	Sample Type	Sample Time	Lab ID	Sample ID	Record ID
5100324	1040	NITRATE	120	0.0	0.10000		080622	101		080422	E	1140	32382	22H0646-01	BROWNKA_27
5100324	1041	NITRITE	120	0.0	0.10000		080622	101		080422	E	1140	32382	22H0646-01	BROWNKA_28
5100324	2378	1,2,4-TRICHLOROBENZE	221	0.0	0.00050		081622	101		080422	E	1140	32382	22H0644-01	BROWNKA_1481
5100324	2380	cis-1,2-DICHLOROETHYLENE	221	0.0	0.00050		081622	101		080422	E	1140	32382	22H0644-01	BROWNKA_1482
5100324	2955	XYLENES (TOTAL)	221	0.0	0.00050		081622	101		080422	E	1140	32382	22H0644-01	BROWNKA_1483
5100324	2964	DICHLOROMETHANE	221	0.0	0.00050		081622	101		080422	E	1140	32382	22H0644-01	BROWNKA_1484
5100324	2968	o-DICHLOROBENZENE	221	0.0	0.00050		081622	101		080422	E	1140	32382	22H0644-01	BROWNKA_1485
5100324	2969	PARA-DICHLOROBENZENE	221	0.0	0.00050		081622	101		080422	E	1140	32382	22H0644-01	BROWNKA_1486
5100324	2976	VINYL CHLORIDE	221	0.0	0.00050		081622	101		080422	E	1140	32382	22H0644-01	BROWNKA_1487
5100324	2977	1,1-DICHLOROETHYLENE	221	0.0	0.00050		081622	101		080422	E	1140	32382	22H0644-01	BROWNKA_1488



E-Government Application for Drinking Water Program

SAFE DRINKING WATER ACT
VIEW/EDIT RECORDS

5100324: MONITEAU JR/SR HIGH SCHOOL

SDWA4

PWSID	Contam ID	Contam	Analysis Method	Result	Lower Limit of Detection	Counting Error	Analysis Date	Loc/EP ID	Loc/EP ID 2	Sample Date	Sample Type	Sample Time	Lab ID	Sample ID	Record ID
5100324	2979	trans-1,2-DICHLOROETHYLENE	221	0.0	0.00050		081622	101		080422	E	1140	32382	22H0644-01	BROWNKA 1489
5100324	2980	1,2-DICHLOROETHANE	221	0.0	0.00050		081622	101		080422	E	1140	32382	22H0644-01	BROWNKA 1490
5100324	2981	1,1,1-TRICHLOROETHANE	221	0.0	0.00050		081622	101		080422	E	1140	32382	22H0644-01	BROWNKA 1491
5100324	2982	CARBON TETRACHLORIDE	221	0.0	0.00050		081622	101		080422	E	1140	32382	22H0644-01	BROWNKA 1492
5100324	2983	1,2-DICHLOROPROPANE	221	0.0	0.00050		081622	101		080422	E	1140	32382	22H0644-01	BROWNKA 1493
5100324	2984	TRICHLOROETHYLENE	221	0.0	0.00050		081622	101		080422	E	1140	32382	22H0644-01	BROWNKA 1494
5100324	2985	1,1,2-TRICHLOROETHANE	221	0.0	0.00050		081622	101		080422	E	1140	32382	22H0644-01	BROWNKA 1495
5100324	2987	TETRACHLOROETHYLENE	221	0.0	0.00050		081622	101		080422	E	1140	32382	22H0644-01	BROWNKA 1496
5100324	2989	CHLOROBENZENE	221	0.0	0.00050		081622	101		080422	E	1140	32382	22H0644-01	BROWNKA 1497
5100324	2990	BENZENE	221	0.0	0.00050		081622	101		080422	E	1140	32382	22H0644-01	BROWNKA 1498
5100324	2991	TOLUENE	221	0.0	0.00050		081622	101		080422	E	1140	32382	22H0644-01	BROWNKA 1499
5100324	2992	ETHYLBENZENE	221	0.0	0.00050		081622	101		080422	E	1140	32382	22H0644-01	BROWNKA 1500
5100324	2996	STYRENE	221	0.0	0.00050		081622	101		080422	E	1140	32382	22H0644-01	BROWNKA 1501