

MONITEAU SCHOOL DISTRICT

MONITEAU HIGH SCHOOL

AUGUST 2020

LEAD & COPPER TESTING

RESULTS



1803 Philadelphia Street
Indiana, PA 15701
P: (724) 463-8378
F: (724) 465-4209
PADEP: 32-00382

1276 Bentleyville Road
Van Voorhis, PA 15366
P: (724) 258-8378
F: (724) 258-8376
PADEP: 63-04247

435 Broad Street
Montoursville, PA 17754
P: (570) 321-9002
F: (570) 321-1957
PADEP: 41-04880

950 West Main Street
Sharpsville, PA 16150
P: (724) 463-8378 x 500
F: (724) 465-4209
PADEP: 43-04934

17 August 2020

Moniteau School District
Attn: Jeffrey Campbell
1810 West Sunbury Road
West Sunbury, PA 16061

Work Order: 0080848
Project: Drinking Water Moniteau Jr/Sr - Lead and Copper
Project Description: Drinking Water

Report of Analysis

Client Sample ID	Lab Sample ID	Matrix	Date Sampled	Date Received	Sample Notes
901	0080848-01	Drinking Water	08/10/2020 05:00	8/10/20 16:00	
902	0080848-02	Drinking Water	08/10/2020 05:05	8/10/20 16:00	
903	0080848-03	Drinking Water	08/10/2020 05:10	8/10/20 16:00	
904	0080848-04	Drinking Water	08/10/2020 05:15	8/10/20 16:00	
905	0080848-05	Drinking Water	08/10/2020 05:20	8/10/20 16:00	
906	0080848-06	Drinking Water	08/10/2020 05:25	8/10/20 16:00	
907	0080848-07	Drinking Water	08/10/2020 05:30	8/10/20 16:00	
908	0080848-08	Drinking Water	08/10/2020 06:00	8/10/20 16:00	
909	0080848-09	Drinking Water	08/10/2020 06:05	8/10/20 16:00	
910	0080848-10	Drinking Water	08/10/2020 06:10	8/10/20 16:00	

Report Narrative

The results contained in this report are only representative of the samples received. Environmental Service Laboratories, Inc. is not responsible for use or interpretation of the data included herein.

Definitions

RL Reporting Limit

Certifications

Analyses performed by Environmental Service Laboratories, Inc., Indiana PA unless otherwise specified.

Environmental Service Laboratories, Inc., Indiana, PA/TNI Certification #32-00382

Approved By

Rebecca Erwin
Project Manager





1803 Philadelphia Street
Indiana, PA 15701
P: (724) 463-8378
F: (724) 465-4209
PADEP: 32-00382

1276 Bentleyville Road
Van Voorhis, PA 15366
P: (724) 258-8378
F: (724) 258-8376
PADEP: 63-04247

435 Broad Street
Montoursville, PA 17754
P: (570) 321-9002
F: (570) 321-1957
PADEP: 41-04880

950 West Main Street
Sharpsville, PA 16150
P: (724) 463-8378 x 500
F: (724) 465-4209
PADEP: 43-04934

Moniteau School District
1810 West Sunbury Road
West Sunbury, PA 16061

Reported: 08/17/2020 09:52

Lab Sample ID#: 0080848-01
Sample Type: Drinking Water
Sample Source: Grab
Sampler: Client
Client Sample ID: 901

Sample Date: 08/10/2020 05:00
Receipt Date: 08/10/2020 16:00

Analyte	Sample Result	Units	Data Qualifier	RL	Analyst/ Certification	Prep Date/Time	Analysis Date/Time
Total Metals		Analytical Method: EPA200.5 4.2			Prep Method: EPA 200.5 4.2		
Copper	0.009	mg/L		0.005	BJL	08/14/20 11:37	08/16/20 16:28
Lead	<0.0025	mg/L		0.0025	BJL	08/14/20 11:37	08/16/20 16:28

Lab Sample ID#: 0080848-02
Sample Type: Drinking Water
Sample Source: Grab
Sampler: Client
Client Sample ID: 902

Sample Date: 08/10/2020 05:05
Receipt Date: 08/10/2020 16:00

Analyte	Sample Result	Units	Data Qualifier	RL	Analyst/ Certification	Prep Date/Time	Analysis Date/Time
Total Metals		Analytical Method: EPA200.5 4.2			Prep Method: EPA 200.5 4.2		
Copper	0.008	mg/L		0.005	BJL	08/14/20 11:37	08/16/20 16:30
Lead	<0.0025	mg/L		0.0025	BJL	08/14/20 11:37	08/16/20 16:30

Lab Sample ID#: 0080848-03
Sample Type: Drinking Water
Sample Source: Grab
Sampler: Client
Client Sample ID: 903

Sample Date: 08/10/2020 05:10
Receipt Date: 08/10/2020 16:00

Analyte	Sample Result	Units	Data Qualifier	RL	Analyst/ Certification	Prep Date/Time	Analysis Date/Time
Total Metals		Analytical Method: EPA200.5 4.2			Prep Method: EPA 200.5 4.2		
Copper	0.043	mg/L		0.005	BJL	08/14/20 11:37	08/16/20 16:32
Lead	<0.0025	mg/L		0.0025	BJL	08/14/20 11:37	08/16/20 16:32



1803 Philadelphia Street
Indiana, PA 15701
P: (724) 463-8378
F: (724) 465-4209
PADEP: 32-00382

1276 Bentleyville Road
Van Voorhis, PA 15366
P: (724) 258-8378
F: (724) 258-8376
PADEP: 63-04247

435 Broad Street
Montoursville, PA 17754
P: (570) 321-9002
F: (570) 321-1957
PADEP: 41-04880

950 West Main Street
Sharpsville, PA 16150
P: (724) 463-8378 x 500
F: (724) 465-4209
PADEP: 43-04934

Moniteau School District
1810 West Sunbury Road
West Sunbury, PA 16061

Reported: 08/17/2020 09:52

Lab Sample ID#: 0080848-04
Sample Type: Drinking Water
Sample Source: Grab
Sampler: Client
Client Sample ID: 904

Sample Date: 08/10/2020 05:15
Receipt Date: 08/10/2020 16:00

Analyte	Sample Result	Units	Data Qualifier	RL	Analyst/ Certification	Prep Date/Time	Analysis Date/Time
Total Metals		Analytical Method: EPA200.5 4.2			Prep Method: EPA 200.5 4.2		
Copper	0.13	mg/L		0.005	BJL	08/14/20 11:37	08/16/20 16:34
Lead	<0.0025	mg/L		0.0025	BJL	08/14/20 11:37	08/16/20 16:34

Lab Sample ID#: 0080848-05
Sample Type: Drinking Water
Sample Source: Grab
Sampler: Client
Client Sample ID: 905

Sample Date: 08/10/2020 05:20
Receipt Date: 08/10/2020 16:00

Analyte	Sample Result	Units	Data Qualifier	RL	Analyst/ Certification	Prep Date/Time	Analysis Date/Time
Total Metals		Analytical Method: EPA200.5 4.2			Prep Method: EPA 200.5 4.2		
Copper	0.009	mg/L		0.005	BJL	08/14/20 11:37	08/16/20 16:36
Lead	<0.0025	mg/L		0.0025	BJL	08/14/20 11:37	08/16/20 16:36

Lab Sample ID#: 0080848-06
Sample Type: Drinking Water
Sample Source: Grab
Sampler: Client
Client Sample ID: 906

Sample Date: 08/10/2020 05:25
Receipt Date: 08/10/2020 16:00

Analyte	Sample Result	Units	Data Qualifier	RL	Analyst/ Certification	Prep Date/Time	Analysis Date/Time
Total Metals		Analytical Method: EPA200.5 4.2			Prep Method: EPA 200.5 4.2		
Copper	0.11	mg/L		0.005	BJL	08/14/20 11:37	08/16/20 16:37
Lead	<0.0025	mg/L		0.0025	BJL	08/14/20 11:37	08/16/20 16:37



1803 Philadelphia Street
Indiana, PA 15701
P: (724) 463-8378
F: (724) 465-4209
PADEP: 32-00382

1276 Bentleyville Road
Van Voorhis, PA 15366
P: (724) 258-8378
F: (724) 258-8376
PADEP: 63-04247

435 Broad Street
Montoursville, PA 17754
P: (570) 321-9002
F: (570) 321-1957
PADEP: 41-04880

950 West Main Street
Sharpsville, PA 16150
P: (724) 463-8378 x 500
F: (724) 465-4209
PADEP: 43-04934

Moniteau School District
1810 West Sunbury Road
West Sunbury, PA 16061

Reported: 08/17/2020 09:52

Lab Sample ID#: 0080848-07
Sample Type: Drinking Water
Sample Source: Grab
Sampler: Client
Client Sample ID: 907

Sample Date: 08/10/2020 05:30
Receipt Date: 08/10/2020 16:00

Analyte	Sample Result	Units	Data Qualifier	RL	Analyst/Certification	Prep Date/Time	Analysis Date/Time
Total Metals		Analytical Method: EPA200.5 4.2			Prep Method: EPA 200.5 4.2		
Copper	0.041	mg/L		0.005	BJL	08/14/20 11:37	08/16/20 16:39
Lead	<0.0025	mg/L		0.0025	BJL	08/14/20 11:37	08/16/20 16:39

Lab Sample ID#: 0080848-08
Sample Type: Drinking Water
Sample Source: Grab
Sampler: Client
Client Sample ID: 908

Sample Date: 08/10/2020 06:00
Receipt Date: 08/10/2020 16:00

Analyte	Sample Result	Units	Data Qualifier	RL	Analyst/Certification	Prep Date/Time	Analysis Date/Time
Total Metals		Analytical Method: EPA200.5 4.2			Prep Method: EPA 200.5 4.2		
Copper	0.062	mg/L		0.005	BJL	08/14/20 11:37	08/16/20 16:41
Lead	<0.0025	mg/L		0.0025	BJL	08/14/20 11:37	08/16/20 16:41

Lab Sample ID#: 0080848-09
Sample Type: Drinking Water
Sample Source: Grab
Sampler: Client
Client Sample ID: 909

Sample Date: 08/10/2020 06:05
Receipt Date: 08/10/2020 16:00

Analyte	Sample Result	Units	Data Qualifier	RL	Analyst/Certification	Prep Date/Time	Analysis Date/Time
Total Metals		Analytical Method: EPA200.5 4.2			Prep Method: EPA 200.5 4.2		
Copper	0.11	mg/L		0.005	BJL	08/14/20 11:37	08/16/20 16:43
Lead	<0.0025	mg/L		0.0025	BJL	08/14/20 11:37	08/16/20 16:43



1803 Philadelphia Street
 Indiana, PA 15701
 P: (724) 463-8378
 F: (724) 465-4209
 PADEP: 32-00382

1276 Bentleyville Road
 Van Voorhis, PA 15366
 P: (724) 258-8378
 F: (724) 258-8376
 PADEP: 63-04247

435 Broad Street
 Montoursville, PA 17754
 P: (570) 321-9002
 F: (570) 321-1957
 PADEP: 41-04880

950 West Main Street
 Sharpsville, PA 16150
 P: (724) 463-8378 x 500
 F: (724) 465-4209
 PADEP: 43-04934

Moniteau School District
 1810 West Sunbury Road
 West Sunbury, PA 16061

Reported: 08/17/2020 09:52

Lab Sample ID#: 0080848-10
Sample Type: Drinking Water
Sample Source: Grab
Sampler: Client
Client Sample ID: 910

Sample Date: 08/10/2020 06:10
Receipt Date: 08/10/2020 16:00

Analyte	Sample Result	Units	Data Qualifier	RL	Analyst/ Certification	Prep Date/Time	Analysis Date/Time
Total Metals	Analytical Method: EPA200.5 4.2				Prep Method: EPA 200.5 4.2		
Copper	0.017	mg/L		0.005	BJL	08/14/20 11:37	08/16/20 16:45
Lead	<0.0025	mg/L		0.0025	BJL	08/14/20 11:37	08/16/20 16:45

ENVIRONMENTAL SERVICE LABORATORIES, INC.

HEADQUARTER
1803 Philadelphia St.
Indiana, PA 15701
(724) 463-TEST
FAX: (724) 465-4209

SOUTHERN DIVISION
1276 Bentleyville Road
Van Voorhis, PA 15366
(724) 258-TEST
FAX: (724) 258-8376

NORTHERN DI
435 Broad Street
Montoursville, F
(570) 321-9003
FAX: (570) 321-1957



0080848

FAX: (724) 465-4209

FOR INTERNAL LABORATORY USE ONLY

Sample Identification	ESL#	Sample Type		Matrix	# of Bottles	Container Type	Analysis Requested
		Date	Time				
1) 901 RM 500	0080848	8/10	05:00	DW	1	PLASTIC LITER HNO3	LEAD AND COPPER
2) 902 RM 503	03	8/10	05:05	DW	1	PLASTIC LITER HNO3	LEAD AND COPPER
3) 903 800 South RR	03	8/10	05:10	DW	1	PLASTIC LITER HNO3	LEAD AND COPPER
4) 904 Admin RR	03	8/10	05:15	DW	1	PLASTIC LITER HNO3	LEAD AND COPPER
5) 905 300 South RR	03	8/10	05:20	DW	1	PLASTIC LITER HNO3	LEAD AND COPPER
6) 906 600 RR	06	8/10	05:25	DW	1	PLASTIC LITER HNO3	LEAD AND COPPER
7) 907 601 Facility	07	8/10	05:30	DW	1	PLASTIC LITER HNO3	LEAD AND COPPER
8) 908 400 North RR	08	8/10	06:00	DW	1	PLASTIC LITER HNO3	LEAD AND COPPER
9) 909 100 North RR	09	8/10	06:06	DW	1	PLASTIC LITER HNO3	LEAD AND COPPER
10) 910 300 North RR	10	8/10	06:10	DW	1	PLASTIC LITER HNO3	LEAD AND COPPER

Notes/Special Instructions:

1. THESE SERVICE CHARGES WILL ACCRUE AT THE RATE OF 1 1/2% PER MONTH (18% PER ANNUM OR THE MAXIMUM ALLOWED BY LAW).

2. THE UNDERSIGNED PURCHASER AGREES TO PAY, IN THE EVENT HIS ACCOUNT BECOMES DELINQUENT AND IS TURNED OVER TO ANY ATTORNEY FOR COLLECTION, REASONABLE ATTORNEY'S FEES PLUS ALL COURT AND ATTENDANT COLLECTION COSTS.

Drinking Water Moniteau Jr/Sr - Lead and Copper (10)

Voluntary NR to DEP

Company/Name: MONITEAU SCHOOL DISTRICT
 Address: 1810 WEST SUNBURY ROAD
 WEST SUNBURY, PA 16061
 Contact Person: JEFFREY CAMPBELL
 Phone Number: 724-406-4426
 Cell Phone: jcampbell@moniteau.k12.pa.us
 Billing Address: 5100324
 PWSID: 5100324

Sampled By: (Signature) Date/ Time 8/10/20 06:15
 Relinquished By: (Signature) Date/ Time 8/10/20 09:25
 Relinquished By: (Signature) Date/ Time 8/10/20 15:55
 Relinquished By: (Signature) Date/ Time 8/10/20 15:10
 Received By: (Signature) Date/ Time 8/10/20 09:25
 Received By: (Signature) Date/ Time 8/10/20 15:10
 Received By: (Signature) Date/ Time 8/10/20 15:10
 Correct Preservations Y / N / NA Correct Containers Y / N / NA Receipt Temperature

1/1/2018

COMMONWEALTH OF PENNSYLVANIA
DEPARTMENT OF ENVIRONMENTAL PROTECTION
BUREAU OF SAFE DRINKING WATER



LEAD & COPPER TAP SAMPLE SITE LOCATION PLAN

GENERAL SYSTEM INFORMATION

Water System Name:	Moniteau Jr. Sr. High School	PWSID:	5100324
Mailing Address:	1810 West Sunbury Road, West Sunbury, PA 16061		
Contact Person Name:	Jeff Campbell	Phone:	724-637-2117 ext. 1770
System Type: (CWS or NTCWS)	NTCWS	E-mail:	jcampbell@moniteau.k12.pa.us
		Population Served:	920

LEAD AND COPPER TAP SAMPLE SITE LISTING

3 Digit Location ID#	Sample Site Address / Room #	Site Location Tier Assignment and LSL status
901	Room 500 - Custodian Break Room Sink	Tier 2
902	Room 503 - Faculty Men's RR Sink	Tier 2
903	Boy's 100 Hall South RR Sink	Tier 2
904	Admin Office Men's RR Sink	Tier 2
905	Boy's 300 Hall South RR Sink	Tier 2
906	Boy's 600 Hall RR Sink	Tier 2

Handwritten signature 1/2/18



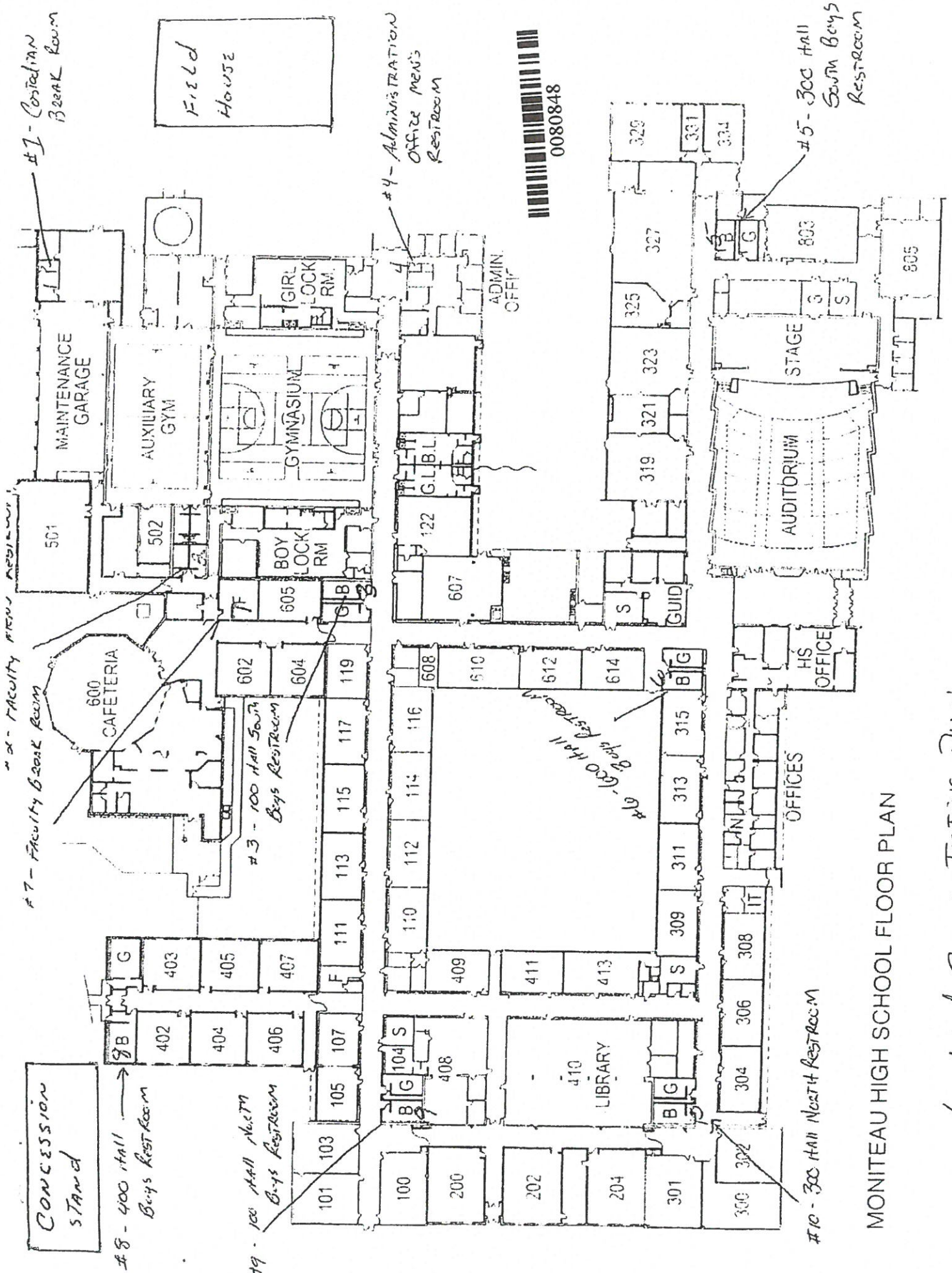

MONITEAU HIGH SCHOOL FLOOR PLAN

Lead And Copper Testing Plan

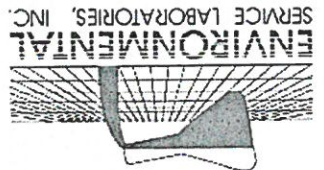

SAMPLE RECEIPT AND REVIEW FORM

PART A: General Information

Client: <u>McArthur</u>		Work Ord: <u>0080848</u>	
Received by: <u>McArthur</u>		Date/Time Received: <u>8/10/2016</u>	
Date Sampled: <u>8/10/2016</u>		Other: _____	
Method of Delivery: <u>Fedex</u>		Client Drop off: <u>ESL-counter</u>	
Other: _____		Other: _____	
Sample Receipt Temp: <u>5.5</u>		Samples Received on Ice: <u>NO</u>	
IR Gun # Used: <u>1 2 3 4</u>		Containers removed by: <u>TCMPN</u> <u>Fecal Coliform</u> <u>TC/EC</u>	
Samples Removed by Satellite Lab Division: <u>Southern(BV)</u> <u>NorthWest(NW)</u> <u>Northern(WP)</u>		Satellite Lab for analysis of: <u>TCMPN</u> <u>ECPN</u>	
Sample State of Collection: <u>PA</u> <u>NY</u> <u>OH</u> <u>WV</u>		PWSID COMPLIANCE DRINKING WATER SAMPLES: <u>YES</u> <u>NO</u>	
Other: _____		Other: _____	

PART B: Receipt Details

Completed (if different from above): _____

Signature _____

Date / /

Time _____

Sample Receipt Criteria	Comments/Qualifiers (Required for Non-Conforming Items)	Deficiency Log Required
1 Chain of custody documents included with samples?	Comments: _____	YES NO
2 COC form is properly signed in relinquished/received sections?	Comments: _____	YES NO
3 Sample containers intact and sealed?	Circle Applicable: <u>Damaged container</u> <u>Leaking container</u> <u>Custody Seal Broken</u> <u>Other: _____</u>	YES NO
4 Number of containers received match number indicated on COC?	Sample ID's affected: _____	YES NO
5 Sample ID's on COC match ID's on bottles?	Sample ID's and containers affected: _____	YES NO
6 Date and time on COC match date and time on bottles?	Sample ID's affected: _____	YES NO
7 Samples received within holding time?	ID's and tests affected: _____	YES NO
8 Samples received at appropriate pH for analysis requested?	Sample ID's, containers affected and observed pH: _____	YES NO
9 Samples requiring thermal preservation within 0 ≤ 6°C? Microbiology within 0 ≤ 10°C?	For non-WV samples outside of thermal preservation range sampled same day and received on ice are considered acceptable condition as the cooling process has begun.	YES NO
11 Adequate sample volume received?	Analyses Affected: _____	YES NO
10 VOA vials free of headspace (defined as < 6mm bubble)?	Sample ID's and containers affected: _____	YES NO
Other Comments: _____		YES NO